

Avermann Maschinenfabrik GmbH & Co. KG, 49078 Osnabrück, Germany

SEF SpaceHub – new centre for precast construction in Singapore

The vision of the government of Singapore is to lead its nation to a carefree and comfortable future. Part of this mission is to cover and expand the housing needs of the population with 700,000 new apartments over a period of 5 to 10 years. On account of this goal the responsible authority, the Building & Construction Authority (BCA) issued an invitation to bid for the first precast hub at the beginning of 2013. The requirements within the framework of the invitation to bid encompassed environmental compatibility aspects and modern production technologies on the one hand and cost analyses and innovations in precast technology on the other.



SEF Construction will put a multi-storey production centre for precast concrete elements into production in 2014

The tailor-made plant concept, planned by Avermann Maschinenfabrik as a multi-storey plant and with which SEF Construction tendered for the project, convinced the jury of the BCA.

Nordimpianti, EVG, Pemat, Nemetschek, DEMAG and SAA are involved in the project as further suppliers in addition to the main supplier Avermann.

The contract for the Precast HUB was officially awarded to the managing director of SEF Construction, Ms. Eileen Ng, by Mr. Lee

Yi Shyan, the Minister of Development, Trade and Industry as well as Dr. John Keung, the CEO of the Building & Construction Authority, on 29 July 2013 in Kaki Bukit in Singapore. The first test run for the SEF SpaceHub is scheduled for mid-2014 and the official start of production will follow in autumn 2014. A detailed report on the new plant will be published exclusively in CPI at a later date.

The successful and impressive opening event in the context of the development and planning of further 'Integrated Construction

and Precast Hubs' (ICPHs) underlined the consistent goal of the government to face the challenges of the future.

FURTHER INFORMATION



SEF Group Pte Ltd
Global Innovation Centre
152 Ubi Ave 4 #03-01
Singapore 408826
T +65 6100 1188
F +65 6288 3688
sef_bizdev@sef.sg
www.sef.sg



Avermann Maschinenfabrik GmbH & Co. KG
Lengericher Landstraße 35
49078 Osnabrück, Germany
T +49 5405 5050
F +49 5405 6441
www.avermann.de

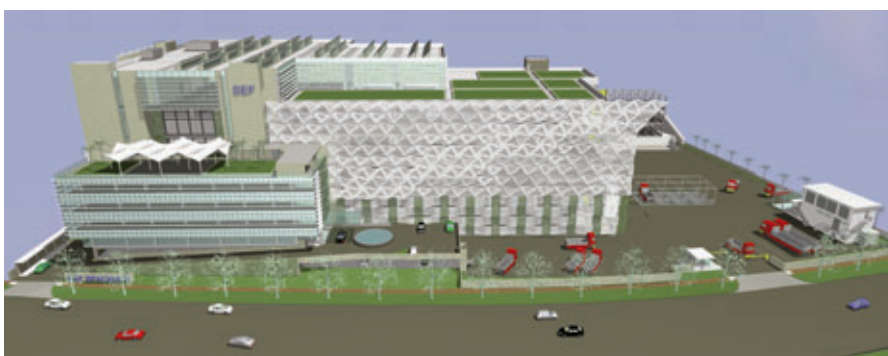

The SEF SpaceHub is planned as a multi-storey plant in accordance with government stipulations